

paneles sandwich  
 29 pza L=06.04m x 1.15m  
 08 pza L=01.06m x 1.15m  
 02 pza L=03.55m x 1.15m

area = 219.35m2

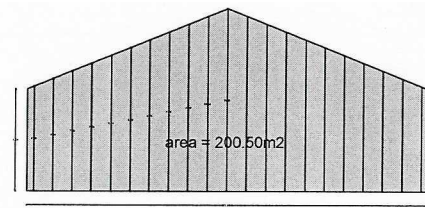

paneles sandwich  
 2 pza L=10.80m x 1.15m  
 2 pza L=10.34m x 1.15m  
 2 pza L=09.88m x 1.15m  
 2 pza L=09.42m x 1.15m  
 2 pza L=08.96m x 1.15m  
 2 pza L=08.50m x 1.15m  
 2 pza L=08.04m x 1.15m  
 2 pza L=07.58m x 1.15m  
 2 pza L=07.12m x 1.15m  
 2 pza L=06.66m x 1.15m  
 1 pza L=06.20m x 1.15m

area = 215.05m2

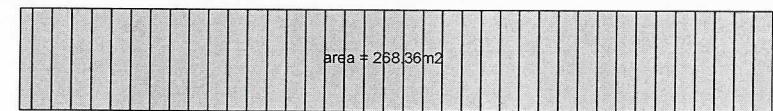

paneles sandwich  
 39 pza L=6.04m x 1.15m  
 area = 270.89m2

